



# EXPANSION JOINT COVERS

INTERIOR & EXTERIOR



**FLOOR / CEILING / WALL / ROOF**

**STAINLESS STEEL / BRONZE / ALUMINUM**

**FIRE RATED (2, 3 & 4 HOURS)**

**HEAVY DUTY, SEISMIC APPLICATIONS**

**EXTERIOR SEALS**



**BALCO INC**

[www.balcousa.com](http://www.balcousa.com)



# INDEX

## FLOOR COVERS

- 6000 Series..... 4
- All Aluminum Floor Covers ..... 6
- No-Bump Floor Covers.....7
- 7500 Elastomeric Floor Covers .....8
- Elastomeric Floor Covers.....9
- 9500 Dual Elastomeric Floor Covers ..... 10
- Surface Mounted Floor Covers..... 12
- Minimal Sight Line Covers ..... 13
- Recessed Gymnasium Floor Covers..... 14
- Topping Slab Floor Covers ..... 15
- Seismic Floor Covers ..... 16
- Extra Wide Floor Covers ..... 17
- Extra-Heavy Duty Floor Covers ..... 18
- Air Terminal Floor Covers..... 20
- Parking Garage Covers..... 20

## FIRE BARRIERS

### METAFLX FIRE BARRIER SYSTEMS

- Floor Fire Barrier ..... 22
- Wall Fire Barrier ..... 22
- MetaFlex 5000
- MetaBlock Fire Barrier ..... 23
- MetaMat Floor Fire Barrier ..... 24
- MetaMat Wall Fire Barrier ..... 25

## WALL AND CEILING

- Clip-In Wall and Ceiling Covers ..... 27
- Surfaced Mounted Wall and Ceiling Covers... 28
- Interior Wall Joint Covers ..... 31
- Gypsum Board Wall and Ceiling Covers..... 32
- Suspended Ceiling Covers..... 34

## EXTERIOR WALL AND ROOF JOINT COVER SYSTEMS

- All Aluminum ..... 34
- Flexible Inserts..... 35
- Factory Roof Transitions..... 36
- Aluminum Roof and Wall Covers ..... 37
- Roof Bellows ..... 38

## PARKING GARAGES & OPEN AIR SYSTEMS

- Exterior Expansion Joint Systems..... 40
- Metal Floor Systems/Heavy Duty Systems.... 44
- Exterior Wall Joint Covers..... 47



{DOWNLOAD CADs AND PDFs}  
[www.balcousa.com](http://www.balcousa.com)



**6FVS-E - FLOOR TO FLOOR**

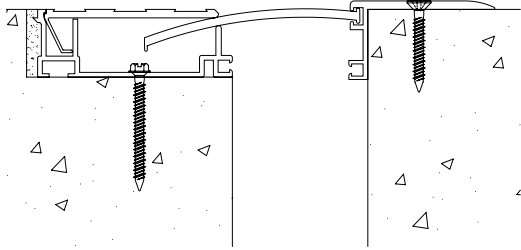

**OPTIONAL COVER PLATE MATERIALS**

6000 Series Floor Covers are Also Available with Stainless Steel and Architectural Bronze Cover Plates.  
(Base Members are Aluminum Extrusions)

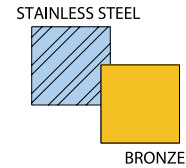

**FEATURES**

- Sliding Aluminum Center Plate - Standard Mill Finish  
(See Optional Cover Plates)
- Aluminum Cover Plate - Standard Mill Finish  
(See Optional Cover Plates)
- Extruded Aluminum Sub-Channel (6063-T5) - Standard Mill Finish
- Blockout Anchors - Standard (Cast-In Anchors - Optional)



Available as 2 Hour Rated System - Balco Fire Barrier Systems are tested in accordance with ASTM E1966 and are listed with Intertek or with Underwriters Laboratories

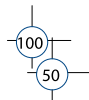

Movement Capabilities - 100% and 50%

**OPTIONAL COVER PLATES**

In Addition to Serrated and Tile Recess Cover Plates, 6000 Series Floor Covers are Available with a Recess for Carpet, an Abrasive Epoxy Fill, or a Plain Plate.

**6FC**

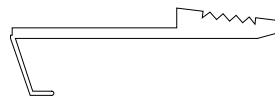

**6FP**

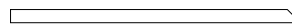

**6FA**



# NO-BUMP FLOOR COVERS

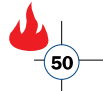

## NBA

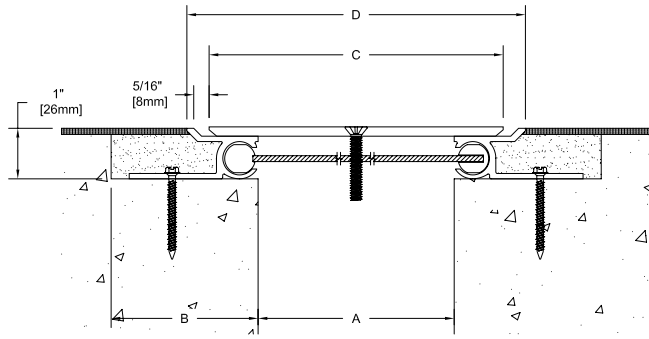

## NBAL

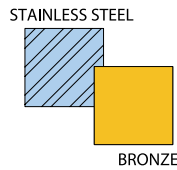
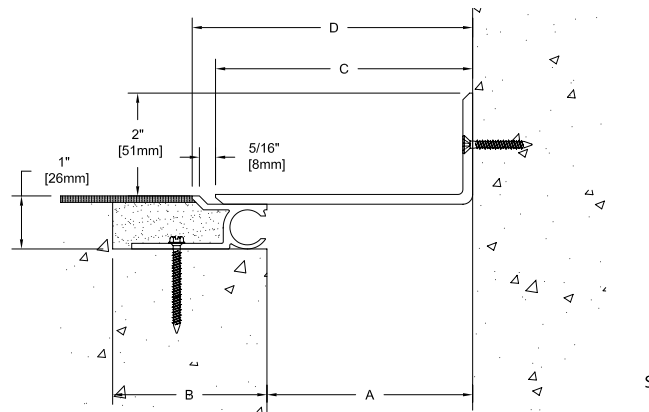

## NBR

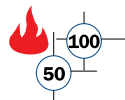
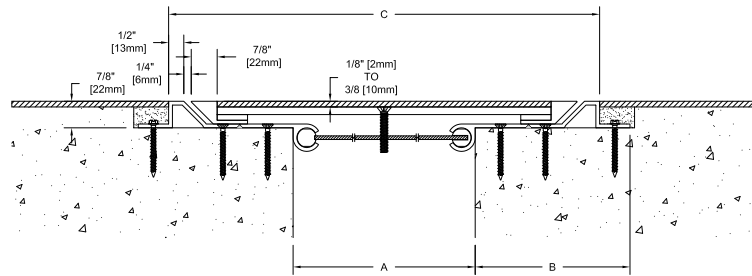

## NBRL

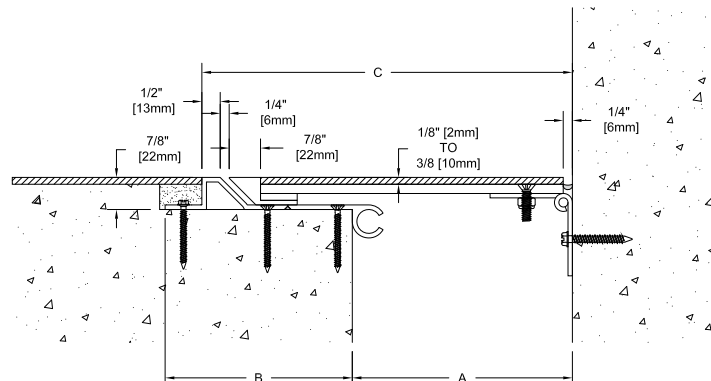

## No-Bump Floor Series

Type	A	B	C	D
<b>NBA-1</b>	1" (25mm)	2 5/8" (67mm)	3" (76mm)	3 15/16" (100mm)
<b>NBA-2</b>	2" (51mm)	2 5/8" (67mm)	4" (102mm)	4 15/16" (125mm)
<b>NBA-3</b>	3" (76mm)	2 5/8" (67mm)	5" (127mm)	5 15/16" (151mm)
<b>NBA-4</b>	4" (102mm)	2 5/8" (67mm)	6" (152mm)	6 15/16" (176mm)
<b>NBA-6</b>	6" (152mm)	2 5/8" (67mm)	9" (229mm)	9 7/8" (251mm)
<b>NBAL-1</b>	1" (25mm)	2 5/8" (67mm)	2" (51mm)	2 7/16" (62mm)
<b>NBAL-2</b>	2" (51mm)	2 5/8" (67mm)	3" (76mm)	3 7/16" (87mm)
<b>NBAL-3</b>	3" (76mm)	2 5/8" (67mm)	4" (102mm)	4 7/16" (113mm)
<b>NBAL-4</b>	4" (102mm)	2 5/8" (67mm)	5" (127mm)	5 7/16" (138mm)
<b>NBAL-6</b>	6" (152mm)	2 5/8" (67mm)	7 1/2" (191mm)	7 15/16" (202mm)

50% Movement Shown - 100% not Available

## OPTIONAL COVER PLATE MATERIALS

NBA/NBAL Series Floor Covers are Also Available with Stainless Steel Cover Plates.  
 (Base Members are Aluminum Extrusions)  
 Specify NBS/NBSL for Stainless Steel and Bronze.

## NBR Pan Seismic Pan System

Type	A	B	C
<b>NBR-4</b>	4" (102mm)	5 1/8" (130mm)	12 3/16" (310mm)
<b>NBR-6</b>	6" (152mm)	5 5/8" (142mm)	15 3/16" (152mm)
<b>NBR-8</b>	8" (203mm)	6 5/8" (168mm)	19 3/16" (488mm)
<b>NBR-10</b>	10" (254mm)	7 5/8" (193mm)	23 3/16" (589mm)
<b>NBR-12</b>	12" (305mm)	8 5/8" (218mm)	27 3/16" (691mm)
<b>NBRL-4</b>	4" (102mm)	5 1/8" (130mm)	8 1/8" (206mm)
<b>NBRL-6</b>	6" (152mm)	5 5/8" (142mm)	10 5/8" (269mm)
<b>NBRL-8</b>	8" (203mm)	6 5/8" (168mm)	13 5/8" (345mm)
<b>NBRL-10</b>	10" (254mm)	7 5/8" (193mm)	16 5/8" (422mm)
<b>NBRL-12</b>	12" (305mm)	8 5/8" (218mm)	19 5/8" (498mm)

Specify depth -1/8, -3/16, -3/8  
 100% Movement Shown - 50% Also Available  
 NBR/NBRL not Available in Stainless Steel

# 7500 ELASTOMERIC FLOOR COVERS

Note: See Pages 28 and 32 for Matching Wall Systems.



**75FP**

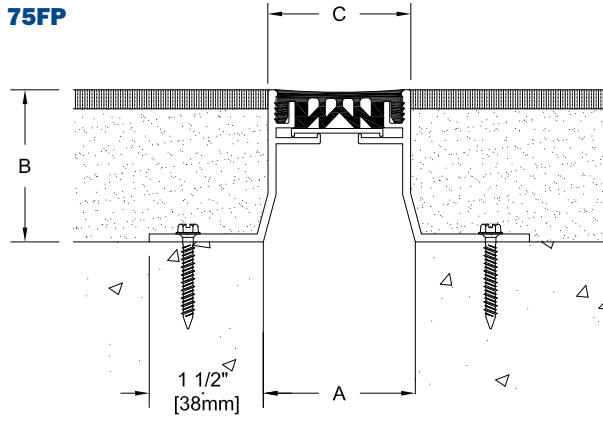

**75FVP**

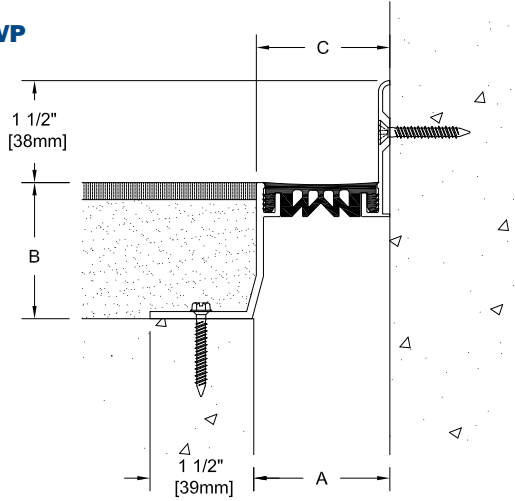

**75FCE**

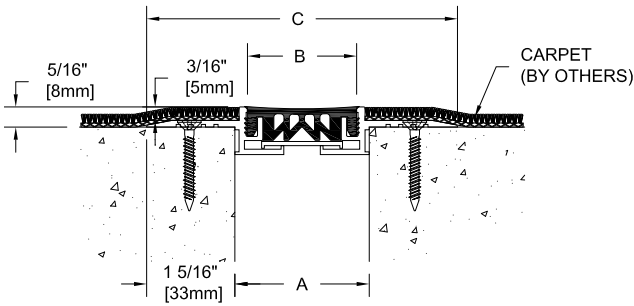

**75FVCE**

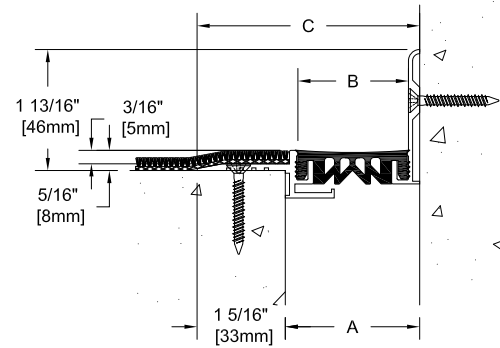

**75FTE**

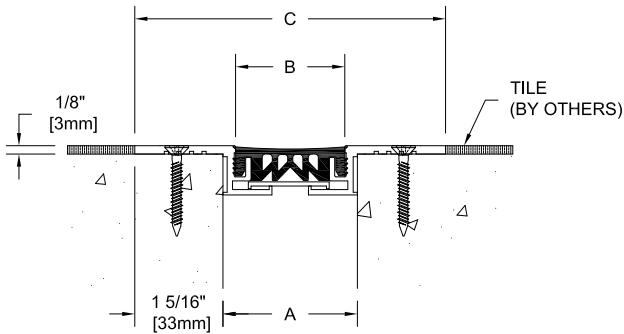

**75FVTE**

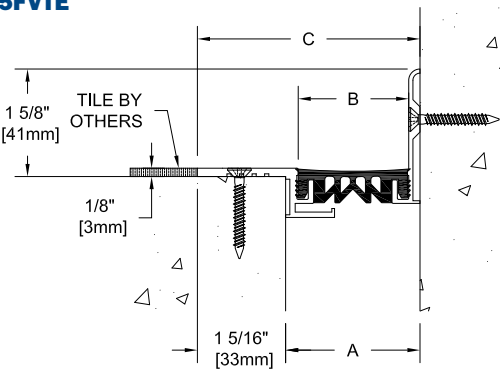

**75FPE**

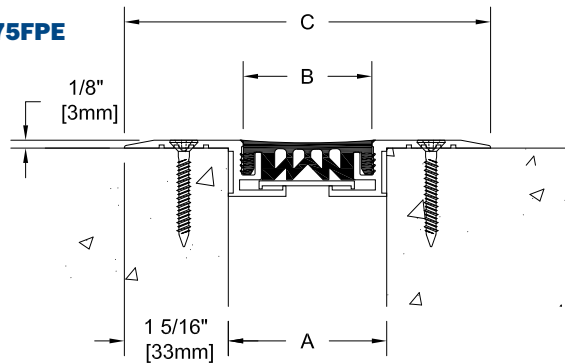

**75FVPE**

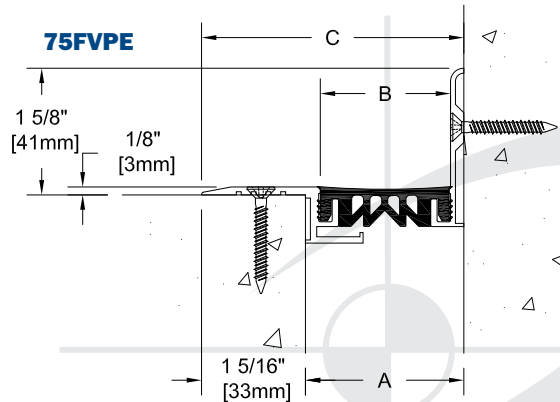

## EXTRA-HEAVY DUTY FLOOR COVERS

This Heavy Duty System is Available with a Serrated Cover Plate or Plain Cover Plate; Specify XH4FS/XH4FVS for Serrated or XH4FP/XH4FVP for Plain.

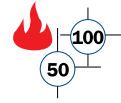

### XH4FS

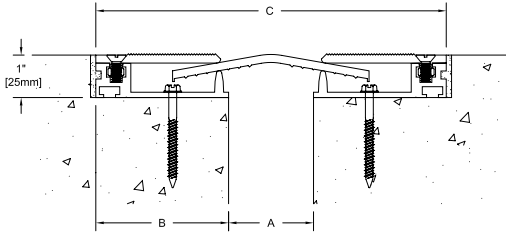

### XH4FVS

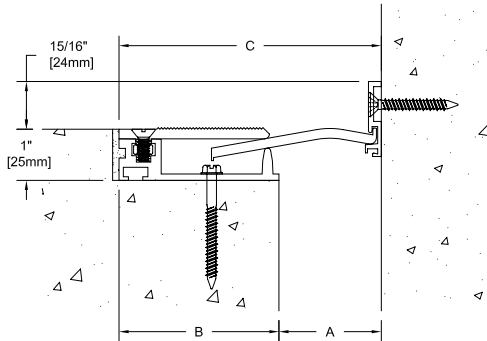

### Extra-Heavy Duty Series

Type	A	B	C	Movement	Max. Concentrated Load for Joint in Neutral Position
<b>XH4FS-1</b>	1" (25mm)	2 1/8" (54mm)	5 1/4" (133mm)	+/- 1" (25mm)	1900 lbs. 8.45 kN
<b>XH4FS-1-2</b>	2" (51mm)	2 1/8" (54mm)	6 1/4" (159mm)	+/- 1" (25mm)	1360 lbs. 6.05 kN
<b>XH4FS-2</b>	2" (51mm)	3 1/8" (79mm)	8 1/4" (210mm)	+/- 2" (51mm)	1540 lbs. 6.85 kN
<b>XH4FS-3</b>	3" (76mm)	4 9/16" (116mm)	1'-0 3/16" (310mm)	+/- 3" (76mm)	1500 lbs. 6.67 kN
<b>XH4FS-4</b>	4" (102mm)	5 9/16" (141mm)	1'-3 3/16" (386mm)	+/- 4" (102mm)	1500 lbs. 6.67 kN
<b>XH4FVS-1</b>	1" (25mm)	2 1/8" (54mm)	3 1/8" (79mm)	+/- 1/2" (13mm)	1900 lbs. 8.45 kN
<b>XH4FVS-1-2</b>	2" (51mm)	2 1/8" (54mm)	4 1/8" (105mm)	+/- 1/2" (13mm)	1360 lbs. 6.05 kN
<b>XH4FVS-2</b>	2" (51mm)	3 1/8" (79mm)	5 1/8" (130mm)	+/- 1" (25mm)	1540 lbs. 6.85 kN
<b>XH4FVS-3</b>	3" (76mm)	4 9/16" (116mm)	1'-0 3/16" (310mm)	+/- 1 1/2" (38mm)	1500 lbs. 6.67 kN
<b>XH4FVS-4</b>	4" (102mm)	5 9/16" (141mm)	1'-3 3/16" (386mm)	+/- 2" (51mm)	1500 lbs. 6.67 kN

#### Notes:

1. Concentrated load is applied to a 2" (51mm) diameter circle.
2. 1 kN = 1000 newtons

### FEATURES

- Sliding Aluminum Center Plate with Aluminum Side Cover Plate - Standard Mill Finish
- Extruded Aluminum Sub-Channel (6063-T5) Standard Mill Finish
- Floor Construction - By Others



Available as 2 Hour Rated System - Balco Fire Barrier Systems are tested in accordance with ASTM E1966 and are listed with Intertek or with Underwriters Laboratories



Movement Capabilities - 100% and 50%

### OPTIONAL COVER PLATE MATERIALS

XH4FS/XH4FP/XH4FVS/XH4FVP Series Floor Cover are Also Available with Stainless Steel and Architectural Bronze Cover Plates. (Base Members are Aluminum Extrusions) Specify SSXH4FS/SSXH4FP/SSXH4FVS/SSXH4FVP for Stainless Steel, BXH4FS/BXH4FP/BXH4FVS/BXH4FVP for Bronze.

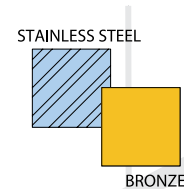

# **FIRE BARRIER SYSTEMS**

---

---

---

# METAFLEX® 5000 METABLOCK™ FIRE BARRIER SYSTEMS



Balco, the industry leader of expansion joint fire barrier systems, is introducing a revolutionary NEW intumescent fire barrier that has been designed to be used in conjunction with Balco's DuraFlex™ Expansion Joint Systems. MetaBlock™ is a two, three or four (2, 3 or 4) hour rated fire barrier composed of a proprietary intumescent material which allows for easy installation with no mechanical fasteners required. Splices and transitions are easily accomplished on-site, cutting installation time in half.

## CS-400

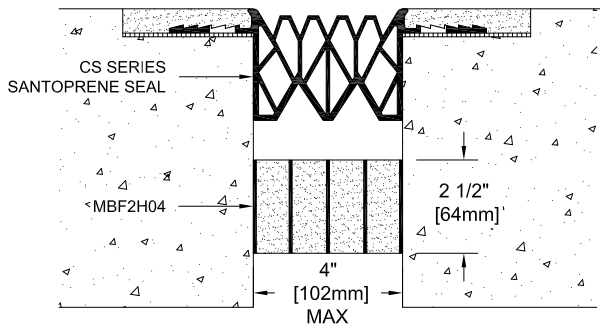

## ES-300

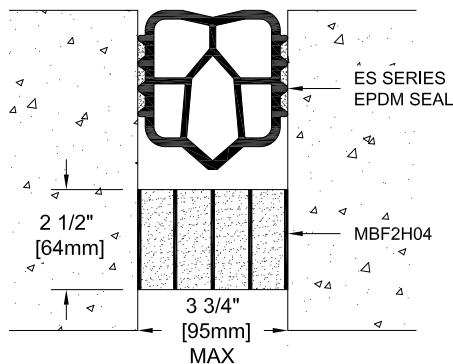

## FS-300

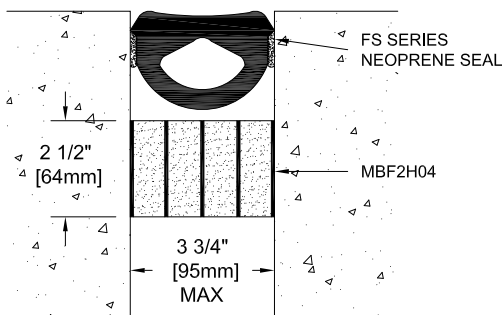

MetaFlex® 5000			
MetaBlock™ - UL Listed			
FLOOR		WALL	
MetaBlock™		MetaBlock™	
MBF2H02	For use with ES and FS series and metal covers with a max open 2" - 2 Hour Rating	MBW2H02	For use with ES and FS series and metal with a max open 2" - 2 Hour Rating
MBF2H04	For use with CS, ES and FS series and metal with a max open 4" - 2 Hour Rating	MBW2H04	For use with ES and FS series and metal with a max open 4" - 2 Hour Rating
MBF3H04	For use with CS, ES and FS series with a max open 4" - 3 Hour Rating		
MBF4H04	For use with CS, ES and FS series with a max open 4" - 4 Hour Rating		

Material sold in 7 foot lengths with tongue & groove ends for easy splicing



# SURFACE MOUNTED WALL AND CEILING COVERS

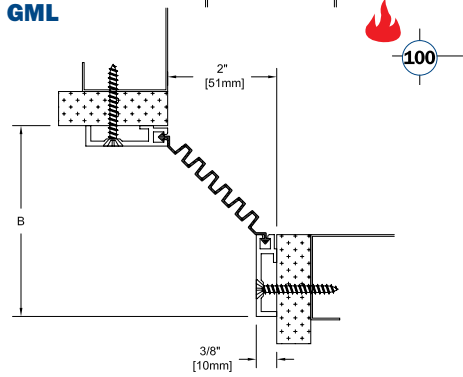
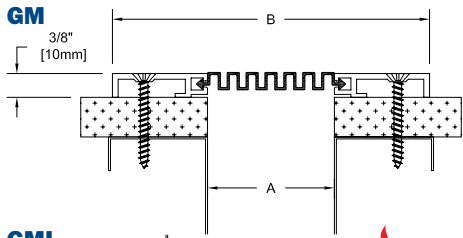

## FEATURES

- Extruded Aluminum Cover Plate, Standard Architectural Class II Anodized
- Extruded Aluminum Clip-Channel (6063-T5) - Standard for WD Series, Standard Architectural Class II Anodized for Vinylines Series
- Extruded Thermoplastic Elastomer Insert

Available as 2 Hour Rated System - Balco Fire Barrier Systems are tested in accordance with ASTM E1966 and are listed with Intertek or with Underwriters Laboratories

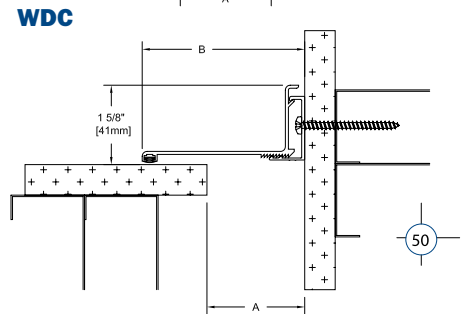
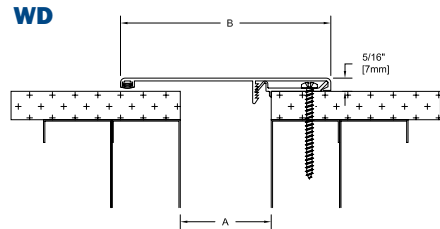

## WD/WDC SERIES OPTIONAL LAMINATES

Stainless Steel or Bronze Available.

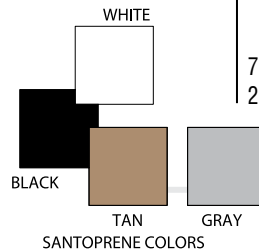
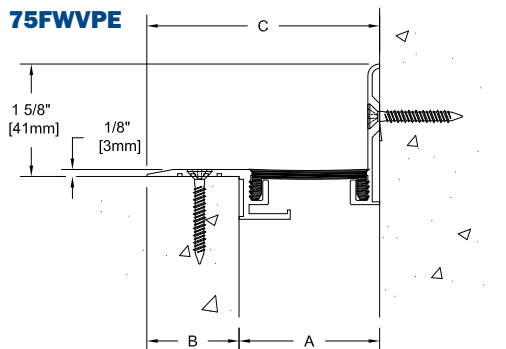
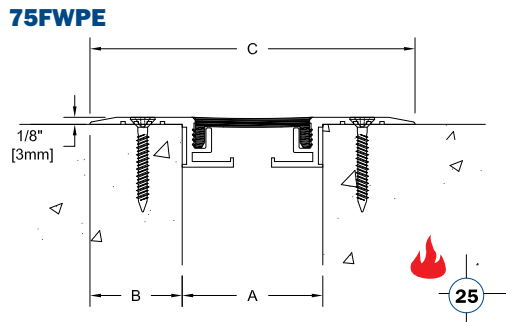
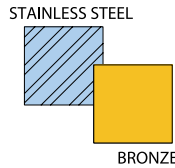

## GM/GML Series

Type	A	B
<b>GM-1</b>	1" (25mm)	4" (102mm)
<b>GML-1</b>	1" (25mm)	2 1/2" (64mm)
<b>GM-2</b>	2" (51mm)	5" (127mm)
<b>GML-2</b>	2" (51mm)	3 1/2" (89mm)
<b>GM-3</b>	3" (76mm)	6" (152mm)
<b>GML-3</b>	3" (76mm)	4 1/2" (114mm)

100% Movement Capabilities

## WD/WDC Series

Type	A	B
<b>WD-1</b>	1" (25mm)	3 1/8" (79mm)
<b>WDC-1</b>	1" (25mm)	1 13/16" (46mm)
<b>WD-2</b>	2" (51mm)	4 5/8" (117mm)
<b>WDC-2</b>	2" (51mm)	3 5/16" (84mm)
<b>WD-3</b>	3" (76mm)	6 1/8" (156mm)
<b>WDC-3</b>	3" (76mm)	4 13/16" (123mm)
<b>WD-4</b>	4" (102mm)	7 5/8" (194mm)
<b>WDC-4</b>	4" (102mm)	6 3/8" (161mm)

50% Movement Capabilities

## 7500 Wall/Ceiling Series

Type	A	B	C
<b>75FWPE-1</b>	1" (25mm)	1 3/8" (36mm)	3 3/16" (97mm)
<b>75FWPE-2</b>	2" (51mm)	1 5/16" (33mm)	4 5/8" (117mm)
<b>75FWVPE-1</b>	1" (25mm)	1 3/8" (36mm)	2 3/8" (61mm)
<b>75FWVPE-2</b>	2" (51mm)	1 5/16" (33mm)	3 5/16" (84mm)

7500 Series Available in 1" (25mm) and 2" (51mm) Only  
25% Movement Capabilities

# GYPSUM BOARD WALL AND CEILING COVERS

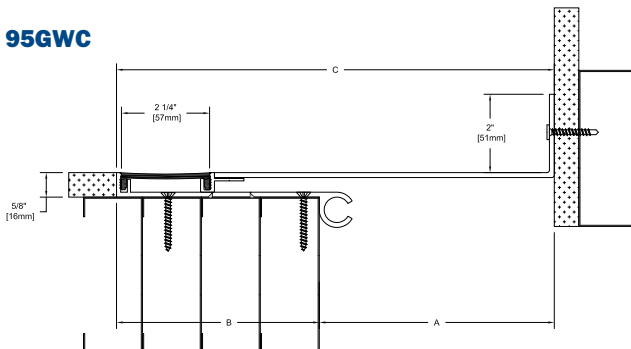
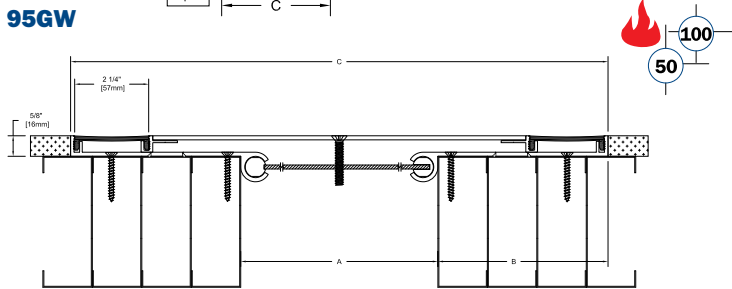
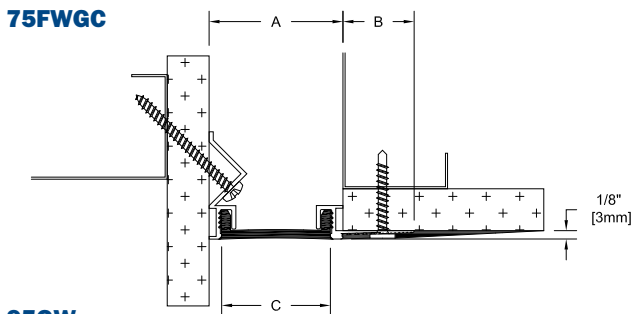
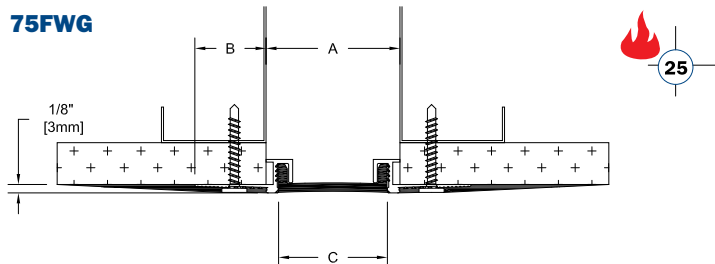
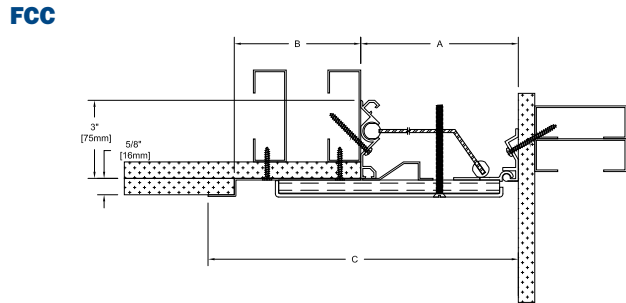
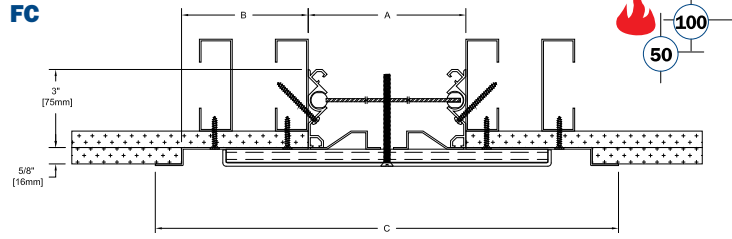

## FC Series Extra-Wide Floor Cover System

Type	A	B	C
<b>FC-4</b>	4" (102mm)	3 13/16" (97mm)	13 5/8" (346mm)
<b>FC-6</b>	6" (152mm)	4 13/16" (122mm)	17 5/8" (448mm)
<b>FC-8</b>	8" (203mm)	5 13/16" (148mm)	21 5/8" (549mm)
<b>FC-10</b>	10" (254mm)	6 13/16" (173mm)	25 5/8" (651mm)
<b>FCC-4</b>	4" (102mm)	3 13/16" (97mm)	8 13/16" (224mm)
<b>FCC-6</b>	6" (152mm)	4 13/16" (122mm)	11 13/16" (300mm)
<b>FCC-8</b>	8" (203mm)	5 13/16" (148mm)	14 13/16" (376mm)
<b>FCC-10</b>	10" (254mm)	6 13/16" (173mm)	17 13/16" (452mm)

100% Movement Shown - 50% Available

## 7500 Wall/Ceiling Series

Type	A	B	C
<b>75FWG-1</b>	1" (25mm)	1 3/16" (30mm)	13/16" (21mm)
<b>75FWG-2</b>	2" (51mm)	1 1/16" (27mm)	1 5/8" (41mm)
<b>75FWGC-1</b>	1" (25mm)	1 3/16" (30mm)	13/16" (21mm)
<b>75FWGC-2</b>	2" (51mm)	1 1/16" (27mm)	1 5/8" (41mm)

7500 Series Available in 1" (25mm) and 2" (51mm) Joint Size Only  
25% movement capabilities

## 9500 Wall/Ceiling Series

Type	A	B	C
<b>95GW-2</b>	2" (51mm)	4 5/8" (117mm)	9 3/8" (238mm)
<b>95GW-3</b>	3" (76mm)	5 5/8" (143mm)	10 3/8" (264mm)
<b>95GW-4</b>	4" (102mm)	6 5/8" (168mm)	11 3/8" (289mm)
<b>95GWC-2</b>	2" (51mm)	3 5/16" (84mm)	5 11/16" (144mm)
<b>95GWC-3</b>	3" (76mm)	4 5/16" (110mm)	6 11/16" (170mm)
<b>95GWC-4</b>	4" (102mm)	5 5/16" (135mm)	7 11/16" (195mm)

Contact Factory for Larger Joint Sizes  
100% & 50% movement capabilities

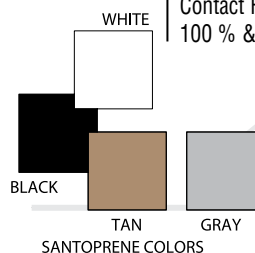



## FACTORY ROOF TRANSITIONS

Balco's Roof Covers, Both Aluminum and Flexible Bellows, are Available with Factory-Made Transitions to Simplify Installation.

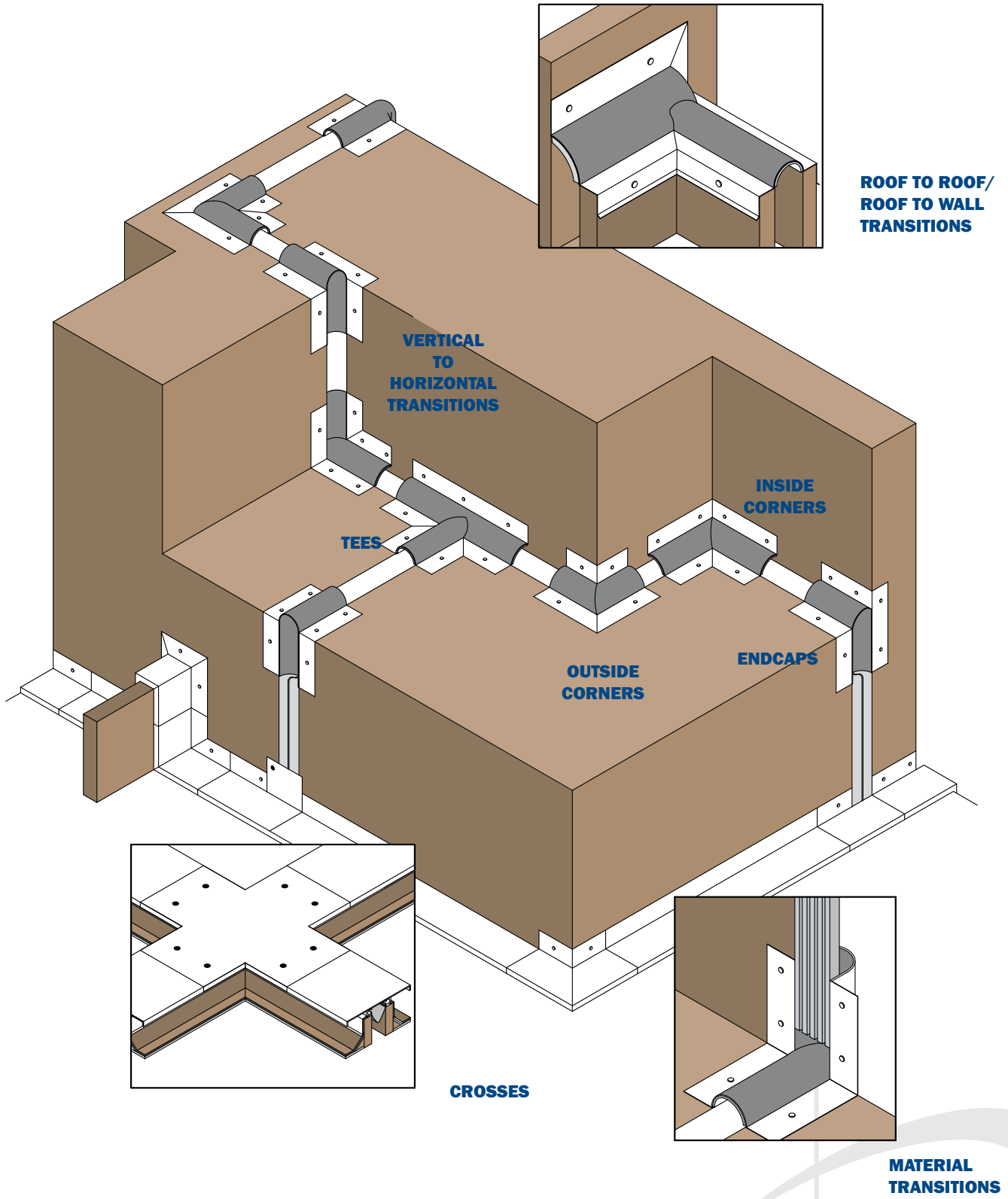

# ALUMINUM WALL AND ROOF COVERS



## 9W

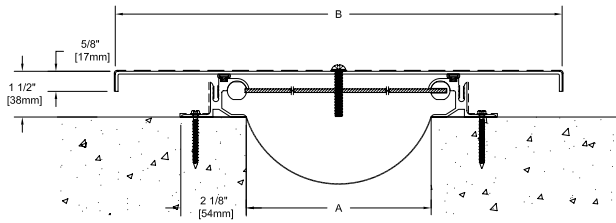

## 9WC

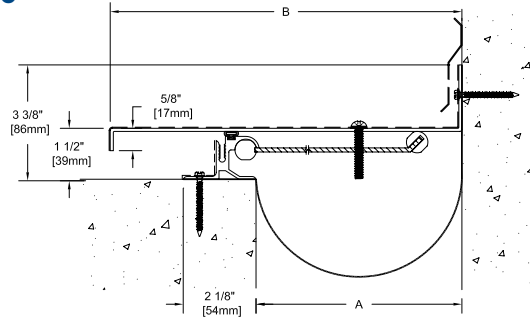

## ALUMINUM ROOF COVERS

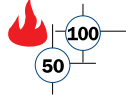

## LPR

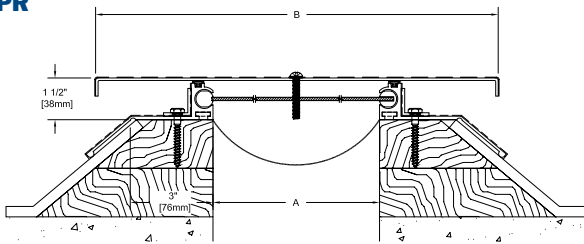

## LPRE

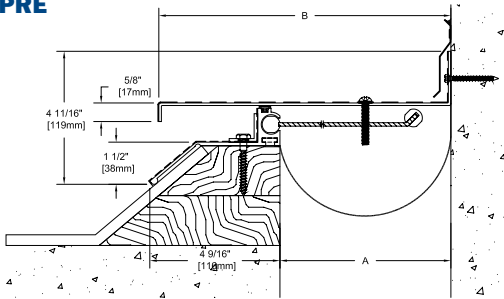

Available as 2 Hour Rated System - Balco Fire Barrier Systems are tested in accordance with ASTM E1966 and are listed with Intertek or with Underwriters Laboratories

## FR

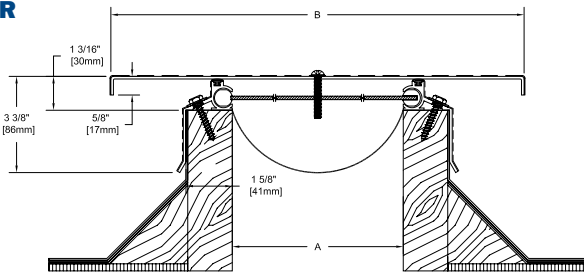

## FRE

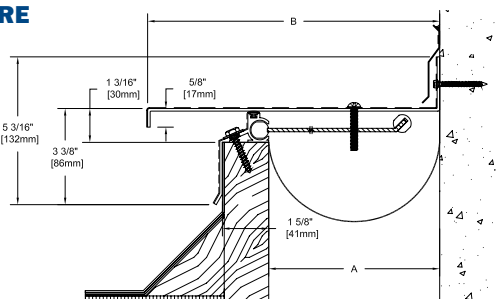

### OPTIONAL COVER PLATE MATERIALS

FR/FRE/LPR/LPRE/9W/9WC Series Roof Covers are Also Available with Stainless Steel Cover Plates. (Base Members are Aluminum Extrusions)  
Specify SSFR/SSFRE/SSLPR/SSLPRE for Stainless Steel.



STAINLESS STEEL

### Aluminum Wall/Roof Series

Type	A	B
9W-2	2" (51mm)	6 3/8" (162mm)
9W-3	3" (76mm)	8 1/2" (216mm)
9W-4	4" (102mm)	10 1/2" (267mm)
9W-6	6" (152mm)	14 1/2" (368mm)
9WC-2	2" (51mm)	4 1/16" (103mm)
9WC-3	3" (76mm)	5 3/4" (146mm)
9WC-4	4" (102mm)	7 1/4" (184mm)
9WC-6	6" (152mm)	10 1/4" (260mm)
LPR-2	2" (51mm)	6 3/8" (162mm)
LPR-3	3" (76mm)	8 1/2" (216mm)
LPR-4	4" (102mm)	10 1/2" (267mm)
LPR-6	6" (152mm)	14 1/2" (368mm)
LPRE-2	2" (51mm)	4 1/16" (103mm)
LPRE-3	3" (76mm)	5 3/4" (146mm)
LPRE-4	4" (102mm)	7 1/4" (184mm)
LPRE-6	6" (152mm)	10 1/4" (260mm)
FR-2	2" (51mm)	6 3/8" (162mm)
FR-3	3" (76mm)	8 1/2" (216mm)
FR-4	4" (102mm)	10 1/2" (267mm)
FR-6	6" (152mm)	14 1/2" (368mm)
FRE-2	2" (51mm)	4 1/16" (103mm)
FRE-3	3" (76mm)	5 3/4" (146mm)
FRE-4	4" (102mm)	7 1/4" (184mm)
FRE-6	6" (152mm)	10 1/4" (260mm)

Contact Factory for Larger Joint Sizes  
100% Movement Shown -  
50% Movement Also Available

# PARKING GARAGES & OPEN AIR STRUCTURES

## EXTERIOR EXPANSION JOINT SYSTEMS

### WING CHAMBERED SEAL SYSTEM

#### CS

Best suited for installation on exposed top slab decks and intermediate slabs of multi-level garages.

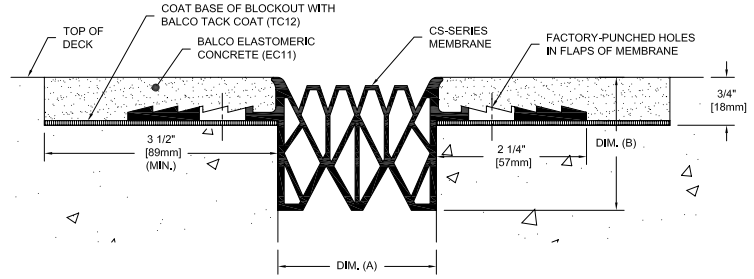

MODEL	MOVEMENT	NOMINAL (A)	MIN (A)	MAX (A)	DIM (B)
<b>CS-250</b>	1 1/2" (38mm)	1 1/2" (38mm)	1" (25mm)	2 1/2" (64mm)	2" (50mm)
<b>CS-325</b>	2" (51mm)	2" (51mm)	1 1/4" (32mm)	3 1/4" (83mm)	2 5/8" (67mm)
<b>CS-400</b>	2 1/2" (64mm)	2 1/2" (64mm)	1 1/2" (38mm)	4" (102mm)	3" (76mm)
<b>CS-500</b>	3 1/4" (83mm)	3" (76mm)	1 3/4" (44mm)	5" (127mm)	3 1/2" (90mm)
<b>CS-600</b>	3 7/8" (98mm)	3 1/2" (89mm)	2 1/8" (54mm)	6" (152mm)	4" (102mm)

### NO WING SEAL SYSTEM

#### NW

Used to seal most types of small movement expansion joints, both vertical and horizontal.

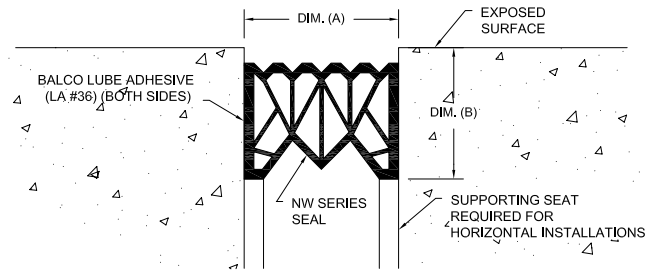

MODEL	MOVEMENT	MIN (A)	MAX (A)	BLOCKOUT (B)	MIDRANGE	MAXIMUM
<b>NW-250</b>	1 1/4" (32mm)	3/4" (19mm)	2" (51mm)	1 7/8" (48mm)	1 1/4" (32mm)	2" (51mm)
<b>NW-300</b>	1 1/8" (29mm)	1 7/16" (37mm)	2 9/16" (65mm)	2 3/8" (60mm)	2" (51mm)	2 9/16" (65mm)
<b>NW-400</b>	2" (51mm)	1 1/2" (38mm)	3 1/2" (89mm)	3 1/4" (83mm)	2 1/2" (64mm)	3 1/2" (89mm)
<b>NW-500</b>	2 1/2" (64mm)	1 3/4" (44mm)	4 1/4" (108mm)	3 3/4" (95mm)	3" (76mm)	4 1/4" (108mm)
<b>NW-600</b>	3" (76mm)	2" (51mm)	5" (127mm)	4 1/2" (114mm)	3 1/2" (89mm)	5" (128mm)

### DUAL CHAMBERED SEAL SYSTEM

#### DCS

Dual-chambered web design allows for greater movement range and can be used in irregular joint openings.

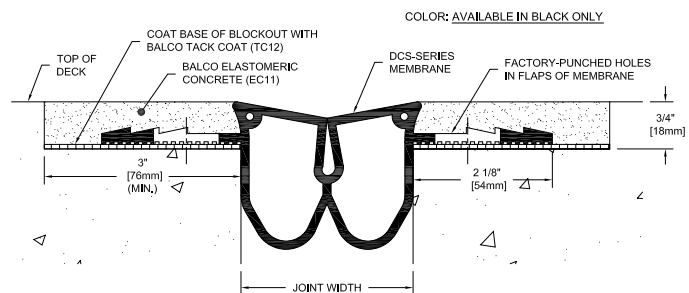

MODEL	INSTALLATION WIDTH			MOVEMENT	
	MINIMUM	PREFERRED	MAXIMUM	MINIMUM	MAXIMUM
<b>DCS-400</b>	1 1/4" (32mm)	2" (51mm)	2 3/4" (70mm)	3/4" (19mm)	4" (102mm)

## ELASTIC SEAL SYSTEM

### ES

Best suited for installation on exposed top slab decks and intermediate slabs of multi-level garages.

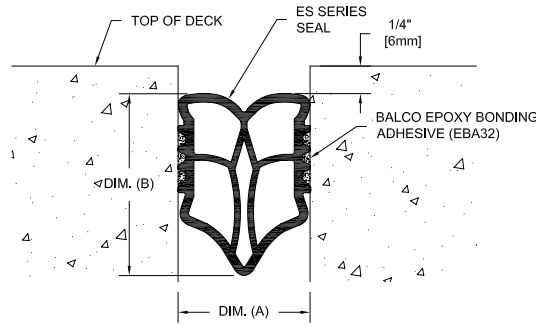

TYPE	ACTUAL SEAL SIZE		NOMINAL JOINT DIMENSIONS		ACTUAL MOVEMENT CAPABILITY		
	WIDTH	DEPTH	WIDTH (A)	DEPTH (B)	MIN (A)	MAX (A)	TOTAL
<b>ES-100</b>	1" (25mm)	1 1/4" (32mm)	1" (25mm)	1 3/4" (44mm)	3/4" (19mm)	1 3/8" (35mm)	5/8" (16mm)
<b>ES-150</b>	1 1/2" (38mm)	1 7/8" (48mm)	1 1/2" (38mm)	2 1/2" (64mm)	1" (25mm)	2" (55mm)	1" (25mm)
<b>ES-200</b>	2" (51mm)	2 1/2" (64mm)	2" (51mm)	3 1/4" (83mm)	1" (25mm)	2 5/8" (67mm)	1 5/8" (41mm)
<b>ES-250</b>	2 1/2" (64mm)	3 1/8" (79mm)	2 1/2" (64mm)	3 3/4" (95mm)	1 3/8" (35mm)	3 1/8" (79mm)	1 3/4" (44mm)
<b>ES-300</b>	3" (76mm)	3 7/8" (98mm)	3" (76mm)	4 1/2" (114mm)	1 5/8" (41mm)	3 3/4" (95mm)	2 1/8" (54mm)

## FLEX SEAL SYSTEM

### FS

Used to seal most types of small movement expansion joints, both vertical and horizontal.

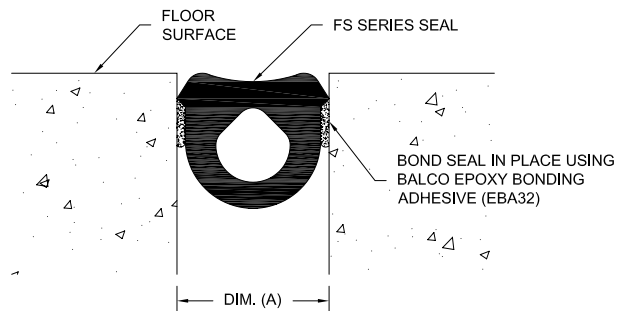

SYSTEM	INSTALL WIDTH	MINIMUM A	MAXIMUM A	MOVEMENT	SEAL SIZE
<b>FS-100</b>	13/16" (21mm)	7/16" (11mm)	1 1/4" (32mm)	13/16" (21mm)	1" (25mm)
<b>FS-150</b>	1 1/4" (32mm)	5/8" (16mm)	1 7/8" (48mm)	1 1/4" (32mm)	1 1/2" (38mm)
<b>FS-200</b>	1 5/8" (42mm)	7/8" (22mm)	2 1/2" (64mm)	1 5/8" (41mm)	2" (51mm)
<b>FS-250</b>	2" (51mm)	1 1/8" (29mm)	3 1/8" (79mm)	2" (51mm)	2 1/2" (64mm)
<b>FS-300</b>	2 7/16" (62mm)	1 3/8" (35mm)	3 3/4" (95mm)	2 3/8" (60mm)	3" (76mm)
<b>FS-400</b>	3 1/4" (83mm)	1 13/16" (46mm)	5" (127mm)	3 3/16" (81mm)	4" (102mm)

Note: Metal Cover required at Pedestrian Areas

# PARKING GARAGES AND OPEN AIR STRUCTURES

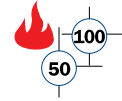

## METAL FLOOR SYSTEMS HEAVY DUTY COVERS

This Heavy Duty System is Available with a Serrated Cover Plate or Plain Cover Plate; Specify XH4FS/XH4FVS for Serrated or XH4FP/XH4FVP for Plain.

### XH4FS

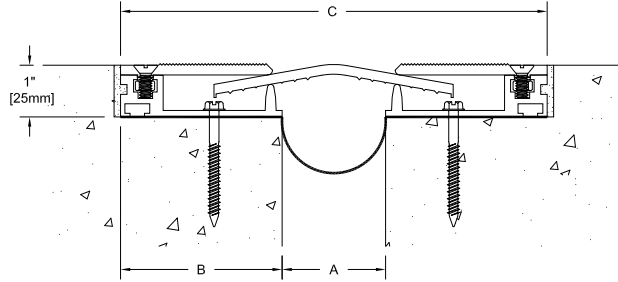

### XH4FVS

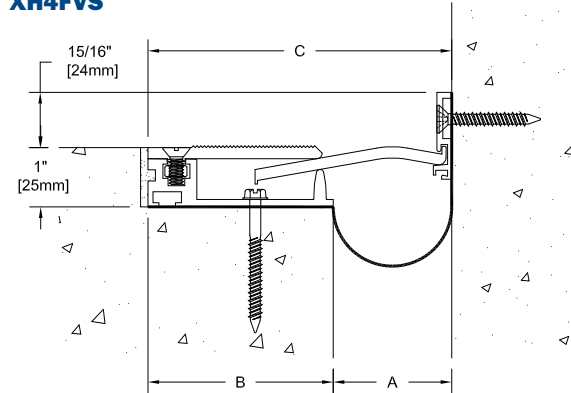

### OPTIONAL COVER PLATE MATERIALS

XH4FS/XH4FP/XH4FVS/XH4FVP  
Series Floor Cover are Also Available with Stainless Steel and Architectural Bronze Cover Plates. (Base Members are Aluminum Extrusions)  
Specify SSXH4FS/SSXH4FP/SSXH4FVS/SSXH4FVP for Stainless Steel, BXH4FS/BXH4FP/BXH4FVS/BXH4FVP for Bronze.

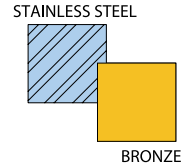

### FEATURES

- Sliding Aluminum Center Plate with Aluminum Side Cover Plate - Standard Mill Finish
- Extruded Aluminum Sub-Channel (6063-TS) - Standard Mill Finish
- Blockout Anchors - Standard (Cast-in Anchors - Optional)



Available as 2 Hour Rated System - Balco Fire Barrier Systems are tested in accordance with ASTM E1966 and are listed with Intertek or with Underwriters Laboratories

Movement Capabilities - 100% and 50%

### Extra-Heavy Duty Series

Type	A	B	C	Movement	Max. Concentrated Load for Joint in Neutral Position
<b>XH4FS-1</b>	1" (25mm)	2 1/8" (54mm)	5 1/4" (133mm)	+/- 1" (25mm)	1900 lbs. 8.45 kN
<b>XH4FS-1-2</b>	2" (51mm)	2 1/8" (54mm)	6 1/4" (159mm)	+/- 1" (25mm)	1360 lbs. 6.05 kN
<b>XH4FS-2</b>	2" (51mm)	3 1/8" (79mm)	8 1/4" (210mm)	+/- 2" (51mm)	1540 lbs. 6.85 kN
<b>XH4FS-3</b>	3" (76mm)	4 9/16" (116mm)	1'-0 3/16" (310mm)	+/- 3" (76mm)	1500 lbs. 6.67 kN
<b>XH4FS-4</b>	4" (102mm)	5 9/16" (141mm)	1'-3 3/16" (386mm)	+/- 4" (102mm)	1500 lbs. 6.67 kN
<b>XH4FVS-1</b>	1" (25mm)	2 1/8" (54mm)	3 1/8" (79mm)	+/- 1/2" (13mm)	1900 lbs. 8.45 kN
<b>XH4FVS-1-2</b>	2" (51mm)	2 1/8" (54mm)	4 1/8" (105mm)	+/- 1/2" (13mm)	1360 lbs. 6.05 kN
<b>XH4FVS-2</b>	2" (51mm)	3 1/8" (79mm)	5 1/8" (130mm)	+/- 1" (25mm)	1540 lbs. 6.85 kN
<b>XH4FVS-3</b>	3" (76mm)	4 9/16" (116mm)	1'-0 3/16" (310mm)	+/- 1 1/2" (38mm)	1500 lbs. 6.67 kN
<b>XH4FVS-4</b>	4" (102mm)	5 9/16" (141mm)	1'-3 3/16" (386mm)	+/- 2" (51mm)	1500 lbs. 6.67 kN

Movement Capabilities - 100% and 50%

#### Notes:

1. Loads are based on 6063-T5 aluminum.
2. Concentrated load is applied to a 2" (51mm) diameter circle.
3. 1 kN = 1000 newtons